

# SUPPLEMENTARY INVESTIGATION REPORT

CLASSIFICATION MISSING PERSONS

Complainant or Victim BERMAN, BARRY ALAN & BERMAN, LOUISE RHODA  
Address \_\_\_\_\_

## EVIDENCE REPORT

AT APPROXIMATELY 1100 HOURS ON SATURDAY, JANUARY 18, 1986 I WAS ADVISED BY LT. GOODRICH TO COLLECT SEVERAL ITEMS OF POSSIBLE EVIDENCE IN SALINE VALLEY AT THE REQUEST OF SGT. DAN LUCAS. I WAS SUBSEQUENTLY TRANSPORTED TO SALINE VALLEY VIA C.N.P. HELICOPTER WHERE I CONTACTED SGT. LUCAS FOR FURTHER INSTRUCTIONS. FROM THE COMMAND POST AREA LOCATED AT THE SALINE VALLEY MINERAL HOT POOLS SGT. LUCAS AND I WERE TRANSPORTED VIA C.N.P. HELICOPTER TO A CABIN ABOUT FIVE MILES EAST OF THE POOLS. AT THIS LOCATION SGT. LUCAS INSTRUCTED ME TO COLLECT INTO EVIDENCE SEVERAL ITEMS REPORTEDLY FOUND BY DETECTIVE NIXON. I TOOK SEVERAL PHOTOGRAPHS OF THE EVIDENCE, THE CABIN, AND SURROUNDING AREAS USING KODAK 1000 ASA 35 MM FILM. I COLLECTED THE ITEMS REQUESTED AND THESE ITEMS ARE LISTED ON PAGE TWO OF THIS REPORT.

Suggest this report be cleared as: REFER TO DETECTIVE DIVISION

Officers DICK WOOD 623 D.W. Wood

Date JANUARY 22 1986 WEDNESDAY

Hour 10:45 HOURS

Approved [Signature]

Rank

SGT

Time

1-23 1986



# SUPPLEMENTARY INVESTIGATION REPORT

CLASSIFICATION MISSING PERSONS

Complainant or Victim BERMAN, BARRY ALAN & BERMAN, LOUISE RHODA  
Address \_\_\_\_\_

## EVIDENCE REPORT

AT 0945 HOURS ON WEDNESDAY, JANUARY 22, 1986 I MAILED VIA U.S. MAIL, A PORTION OF EVIDENCE ITEM #7 SLATE TO THE FRESNO LAB OF THE CALIFORNIA DEPARTMENT OF JUSTICE. A COPY OF THE REQUEST FOR ANALYSIS IS ATTACHED AS PAGE 4 OF THIS REPORT.

AT 1100 HOURS ON WEDNESDAY, JANUARY 22, 1986 I PLACED THE MAJOR PORTION OF EVIDENCE ITEM #7 SLATE AND EVIDENCE ITEMS 1, 2, 3, 4, 5, & 6 IN EVIDENCE BIN #15 OF THE SHERIFF'S BISHOP SUB STATION EVIDENCE LOCKER.

AT APPROXIMATELY 1000 HOURS ON SUNDAY, JANUARY 19, 1986 I PHOTOGRAPHED THE CONTENTS OF BERMAN'S 1982 DATSUN PICK UP TRUCK AT THE BISHOP SUB STATION USING KODAK EKTACHROME 35MM FILM. THE CALIF. #3805 TRUCK AND CONTENTS WERE RELEASED TO BARRY BERMAN'S FATHER AFTER PHOTOGRAPHING.

Suggest this report be cleared as: REFER TO DETECTIVE DIVISION

Officers DIANE WOOD 623 Bill Wood

Date JANUARY 22, 1986 WEDNESDAY

Hour 1112 HOURS

Approved [Signature]

Rank SGT

Time 1-23 1986

REQUESTING AGENCY  
NCIC #

CA01400

CALIFORNIA DEPARTMENT OF JUSTICE  
DIVISION OF LAW ENFORCEMENT  
BUREAU OF FORENSIC SERVICES

86-01-057

PAGE 4

1-22-86

REQUEST FOR  
PHYSICAL EVIDENCE EXAMINATION

REQUESTING AGENCY: INYO COUNTY SHERIFF'S DEPT...... COUNTY OF: INYO.....

OFFENSE: 187 P.C...... DATE OF OFFENSE: 1-18-86 / 1-17-86..... AGENCY CASE # 86-01-057.....

SUSPECT(S) UNKNOWN!.....

VICTIM(S) BERMAN, BARRY ALAN & BERMAN, LOUISE RHODA.....

Investigating Officer: DET. NIXON / DICK WOOD..... Phone # 619-872-7341.....

DATE NEEDED: NOT DETERMINED..... Purpose: INVESTIGATIVE / EVIDENCE.....

Attach copy of report or state summary of circumstances: THE VACATIONING BERMAN'S WALKED AWAY FROM THEIR TRUCK IN DEATH VALLEY. EXTENSIVE SEARCH & RESCUE EFFORTS FRUITLESS. ALL PERSONAL EFFECTS LEFT IN TRUCK AND NOT CONSISTENT WITH BERMAN'S BEHAVIOR-LIFE STYLE. FOUL PLAY SUSPECTED. ON SCENE PSYCHIC CONSULTED. BELIEVES WEATHER COUPLE DEAD. SLATE WITH BLOOD FOUND NEAR CABIN IN AREA OF BERMAN'S DISAPPEARANCE. PROBABLY USED TO CLEAN RABBIT. T. J. Wood.....

PROPERLY MARK AND PACKAGE ALL EVIDENCE

EVIDENCE SUBMITTED

Item #	Description	Purpose of Exam
1	SLATE TILE W/ BLOOD & HAIRS	DETERMINE IS BLOOD HAIR IS HUMAN

ATTACH ADDITIONAL SHEETS AS REQUIRED

CHAIN OF CUSTODY

Item #	Received From	Delivered To	Date	Time
1	DICK WOOD / INYO COUNTY			

PLACE THIS FORM IN ENVELOPE ON OUTSIDE OF EVIDENCE PACKAGE

# SUPPLEMENTARY INVESTIGATION REPORT

CLASSIFICATION MISSING PERSONS

Complainant or Victim BERMAN, BARRY ALAN & BERMAN, ROUSE RHODA  
Address \_\_\_\_\_

## CRIME SCENE SKETCH

CABIN AT SALINE VALLEY

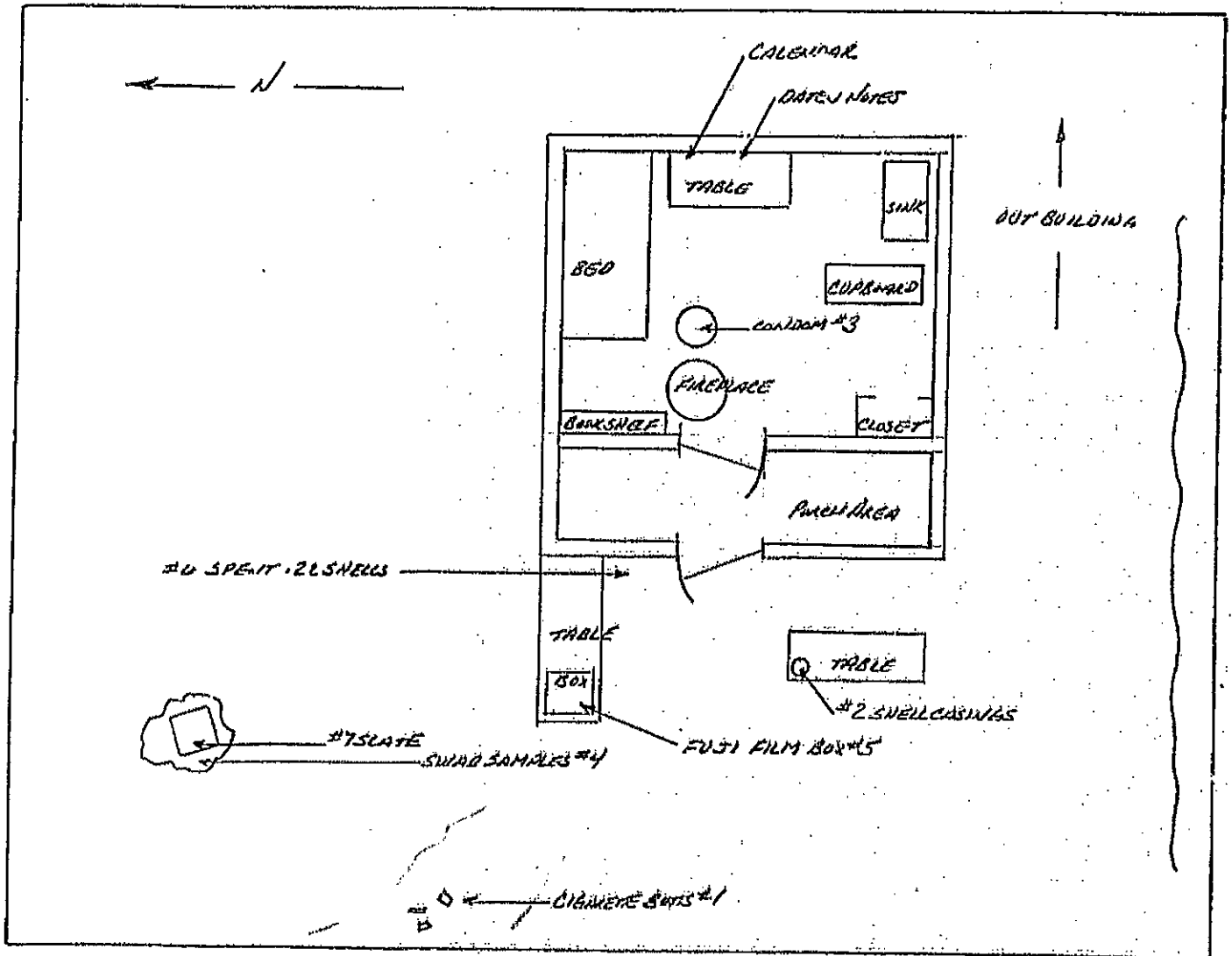

\*Sketch is for illustrative purposes only and is not necessarily to proportion. Measurements and angles are approximate.

Suggest this report be cleared as: REFER TO DETECTIVE DIVISION

Officer Dick Wood #623 T.L.U. Smith

Date JANUARY 22, 1986 WEDNESDAY

Hour 12:30 PM

Approved [Signature] Rank Sgt.

Time 1-23 1986

# SUPPLEMENTARY INVESTIGATION REPORT

CLASSIFICATION MISSING PERSONS

Complainant or Victim BERNARD, BARRY ALAN & DENMAN, LOUISE RHOEA  
 Address \_\_\_\_\_

### PHOTOGRAPH INFORMATION

Camera MILLETTA Film KODAK VA 1000 Roll No. 1 Date Taken: 1-18-86  
 Other Info: \_\_\_\_\_

#	Neg.	Direction	Time	Description
1	9	NORTHEAST	1500	ROCK W/ STRIPES, BLOOD STAINS, SLATE W/ BLOOD NEAR CABIN
2	10	SOUTHEAST	1502	CABIN WITH ROCK IN FOREGROUND.
3	11	DOWN	1504	(2) CIGARETTE BUTTS IN WASH TAP MEASURE
4	12	EAST	1506	CALENDAR EAST INTERIOR WALL OF CABIN
5	13	EAST	1508	NOTE. EAST WALL OF INTERIOR WALL OF CABIN
6	14	EAST	1510	NOTE. EAST WALL OF INTERIOR WALL OF CABIN
7	15	DOWN	1512	BUCKET & CONDOM IN CABIN
8	16	EAST	1514	EAST INTERIOR WALL OF CABIN, TABLE, GENERAL VIEW
9	17	DOWN	1516	SCREEN & 9MM SPENT CASING
10	18	DOWN	1518	BUCKET & FUJI FILM BOX, COKE CANS.
11	19	DOWN	1520	RED PLASTIC GLASS & SPENT SHELLS
12	20	WEST	1522	THERMOMETER W. OF CABIN.

THE ABOVE PHOTOGRAPHS WERE RECEIVED FROM WILSON'S PROCESSING BY WOOD AT 1130 HOURS, THURSDAY 1-30-86 AND PLACED IN THE PHOTO EVIDENCE FILE ON 2-1-86 BY WOOD

Request this report be cleared as: REFER TO DETECTIVE DIVISION

Prepared by: Dick Wood #623 R.W. Wood

Date: 2-1-86 SATURDAY

Hour: 2800

Approved: J.J. Kog Rank: Sgt.

Time: 2175 @ 2/01/86

# SUPPLEMENTARY INVESTIGATION REPORT

CLASSIFICATION MISSING PERSONS

Complainant or Victim BERMAN, BARRY ALAN & BERMAN, LOUISE RHODA  
Address \_\_\_\_\_

## PHOTOGRAPH INFORMATION

AT 1130 HOURS, THURSDAY, 1-30-86 I RECEIVED (2) BOXES CONTAINING A TOTAL OF 30 EXTACHROME SLIDES FROM WILSON'S PHARMACY SUBSEQUENT TO KODAK PROCESSING. THE SLIDES ARE THOSE PHOTOGRAPHS I TOOK ON 1-19-86 OF THE ITEMS CONTAINED IN THE DATSUN TRUCK AND MENTIONED ON PAGE 3 OF THIS REPORT. IN ADDITION TO THE PROPERTY ITEMS I PHOTOGRAPHED EACH SIDE OF THE TRUCK AND THE ODOMETER FOR POSSIBLE FUTURE REFERENCE. I PLACED THE SLIDES IN THE BISHOP SUB STATION PHOTO EVIDENCE FILE ON 2-1-86.

Suggest this report be cleared as: REFER TO DETECTIVE DIVISION

Officers DICK WOOD 623 P.H. Woods

Date 2-1-86 SATURDAY

Hour 0820 HOURS

Approved [Signature]

Rank Sgt.

Time 2130 02/01 1986

# SUPPLEMENTARY INVESTIGATION REPORT

CLASSIFICATION MISSING PERSONS

Complainant or Victim BERMAN, BARRY ALAN & BERMAN, LOUISE RHODA  
Address \_\_\_\_\_

EVIDENCE RETAINED:

AT 1050 HOURS ON FRIDAY, FEBRUARY 7, 1986 I RECEIVED EVIDENCE #7 FROM D.O.J. WITH AN ANALYSIS REPORT. THE D.O.J. CASE NO. FR-C-030-6 ANALYSIS REPORT INDICATED THAT THE HAIR ON THE SLATE IS NON HUMAN AND CONSISTANT WITH BEING RABBIT. A XEROX COPY OF THE DOT IS INCLUDED AS PAGE 9 OF THIS REPORT. I PLACED THE EVIDENCE IN BIN #15 OF THE BISHOP SUB STATION EVIDENCE LOCKER.

Suggest this report be cleared as: REFER TO DETECTIVE DIVISION

Officers DICK WOOD 623 R.H. Wood

Date 2-7-86 FRIDAY

Hour 1100 HOURS

Approved S.J. Roe

Rank Sgt.

Time 0135 02/08 1986



REQUESTING AGENCY NO  
86-01-057

CALIFORNIA DEPARTMENT OF JUSTICE  
DIVISION OF LAW ENFORCEMENT  
BUREAU OF FORENSIC SERVICES

BFS CASE NO.  
FR-G-030-6

FRESNO REGIONAL CRIMINALISTICS LABORATORY  
6014 NORTH CEDAR, FRESNO 93710

86-01-057  
PAGE 9

To: Inyo County Sheriffs Office  
Drawer S  
Independence, California 93526

Copies To:

Attention: Dick Wood

PHYSICAL EVIDENCE EXAMINATION REPORT

TYPE OF CASE 187 P.C. (HOMICIDE)		REQUESTING AGENCY Inyo County Sheriffs Office	
SUBJECT BERMAN, Barry Allan and Louise Rhoda			
EXHIBITS RECEIVED FROM Dick Wood	DATE 1/24/86	TIME	
METHOD OF TRANSIT Mail			

This is a report concerning physical evidence examinations requested by your office. In any future correspondence regarding this case please use the BFS case number appearing at the top of this report.

The undersigned, a Criminalist employed by the State of California, if called as a witness, would testify, under penalty of perjury, that he/she did perform the examinations, tests and analyses necessary to reach the findings, opinions and conclusions stated below.

SUMMARY:

No evidence of human blood or hair was detected on the tile.

*Rec'd 2-7-86  
1050 AM  
R. Wood*

EVIDENCE AND INDICATED SOURCE:

The following evidence was received by United States Mail from the Inyo County Sheriffs Office on January 24, 1986:

1. A slate tile bearing blood and hair

EXAMINATIONS:

The hair adhering to the tile is non-human and is consistent with being from a rabbit.

DISPOSITION:

The evidence is being returned by United Parcel Service.

Date of Report: January 29, 1986

Examinations by: KENNETH R. PENNER

ERI:eat

Title: CRIMINALIST

*WRC  
1-30-86*

# SUPPLEMENTARY INVESTIGATION REPORT

CLASSIFICATION MISSING PERSONS

Complainant or Victim BERMAN, BARRY ALAN & BERMAN, LOUISE RHODA

Address \_\_\_\_\_

## EVIDENCE REPORT

AT APPROXIMATELY 1430 HOURS ON FEBRUARY 6, 1986 I RECEIVED A GROCERY BAG CONTAINING GARBAGE AND TRASH FROM DETECTIVE RANDY NIXON. THE ITEMS ARE INDIVIDUAL LISTED ON PAGE 10 OF THIS REPORT.

AT 0730 HOURS ON 2-7-86 I PLACED THE TRASH ITEMS IN A TANK AND FUMED THE ITEMS WITH LOCKTITE CYANOACRYLATE UNTIL 2300 HOURS ON 2-12-86. I REMOVED THE ITEMS AND DUSTED WITH BOTH STANDARD POWDERS AND MAGNETIC POWDERS. THE TWO SMALL CANS AND TWO CAN LIDS YIELDED ABOUT SIX PARTIAL LATENT PRINTS. THE CANS AND LIDS WERE PHOTOGRAPHED ON EXTACHROME FILM AND PLUS-X FILM. NO ATTEMPT HAS BEEN MADE TO DATE TO LIFT THE PRINTS. THE LATENT PRINTS WERE PHOTOGRAPHED. ADDITIONAL WORK WILL BE PERFORMED REGARDING THE LATENT PRINTS.

Suggest this report be cleared as: REFER TO DETECTIVE DIVISION

Officers DICK WOOD 623 T.H. Wood

Date FRIDAY 2-14-86

Hour 0230

Approved [Signature]

Rank Sgt

Time 2-14-1986



REQUESTING AGENCY  
NCIC#

CA01400

DIVISION OF LAW ENFORCEMENT  
BUREAU OF FORENSIC SERVICES

New  Additional   
Resubmitted

86-01-057  
PAGE 12

REQUEST FOR  
PHYSICAL EVIDENCE EXAMINATION

REQUESTING AGENCY: INYO COUNTY SHERIFF'S DEPT COUNTY OF: INYO

OFFENSE: MISS. PERS. DATE OF OFFENSE: 1-6-86 AGENCY CASE # 86-01-057

SUSPECT(S): UNKNOWN

VICTIM(S): BERMAN, BERRY ALAN 11-27-50 BERMAN, LOUISE RHOAA 12-29-53

Investigating Officer: DET. RANDY NIXON DICK WOOD Phone # 619-872-7361

DATE NEEDED: NONE Purpose: .....

Attach copy of report or state summary of circumstances: ATTACHED

ITEM #S ARE INYO SID EVIDENCE NUMBERS.

PROPERLY MARK AND PACKAGE ALL EVIDENCE

EVIDENCE SUBMITTED

Item #	Description	Purpose of Exam
14	EMPTY KONA'S MUSHROOM CAN	ATTACHED
15	CAN LID W/ "MPS 5320" IMPRESSED	"
16	EMPTY DELMONTE PUDDING CUP CAN	"
17	AL. PULL-TAB CAN LID	"
	<i>Randy Nixon</i>	

ATTACH ADDITIONAL SHEETS AS REQUIRED

CHAIN OF CUSTODY

Item #	Received From	Delivered To	Date	Time
14, 15, 16, 17	DICK WOOD 1050			

PLACE THIS FORM IN ENVELOPE ON OUTSIDE OF EVIDENCE PACKAGE

OSJR, Sy

OFFICE OF SHERIFF

Report No. 86-01-057

COUNTY OF INYO, CALIFORNIA

# SUPPLEMENTARY INVESTIGATION REPORT

CLASSIFICATION Missing Persons

Complainant or Victim Berman, Barry and Berman Louise

Address \_\_\_\_\_

Further Investigation on above Case we report as follows:

## Evidence!

I received a sealed package from D.O.J. reportedly containing the items I had previously searched for prints and forwarded to D.O.J. for further development. Attached to this report is the report and evidence description of those items.

I placed the above sealed box in Evidence Bin #21 of the Sheriff's Bishop Sub station. A copy of the original D.O.J. report is attached to the package.

The "usable latent impression" referred to in the D.O.J. report was given to Detective Randy Nixon on 3-31-86 by myself for the purpose of limiting chain of custody.

Suggest this report be cleared as: Refer to Detective Division

Officers Sgt. Dick Wood #616 *Dick Wood*

Date April 1, 1986 Tuesday

Hour 1255 hours

Approved *[Signature]*

Rank Sgt.

Time 4-7-86

REQUESTING AGENCY NO.

86-01-057

CALIFORNIA DEPARTMENT OF JUSTICE  
DIVISION OF LAW ENFORCEMENT  
BUREAU OF FORENSIC SERVICES

BFS CASE NO.

FR-L-066-86

FRESNO REGIONAL CRIMINALISTICS LABORATORY  
6014 NORTH CEDAR, FRESNO 93710

86-01-057

To: Into County Sheriff's Office  
Post Office Box 5  
Independence, CA 93526

Copies To:

ATTN: Det. Randy Nixon

## PHYSICAL EVIDENCE EXAMINATION REPORT

TYPE OF CASE		REQUESTING AGENCY	
Missing Persons		Inyo County Sheriff's Office	
SUBJECT			
UNKNOWN			
EXHIBITS RECEIVED FROM	DATE	TIME	
Det. Nixon	2/19/86		
METHOD OF TRANSIT			
In Person			

*This is a report concerning physical evidence examinations requested by your office. In any future correspondence regarding this case please use the BFS case number appearing at the top of this report.*

The undersigned, a Latent Print Analyst employed by the State of California, if called as a witness, would testify, under penalty of perjury, that he/she did perform the examinations, tests and analyses necessary to reach the findings, opinions and conclusions stated below.

SUMMARY:

Examination of the previously processed items revealed one usable latent impression and numerous fragmentary impressions of no value.

EVIDENCE AND INDICATED SOURCE:

1. Empty Von's mushroom can (previously processed).
2. Empty DelMonte pudding can (previously processed).
3. Two can lids (previously processed).

DISPOSITION:

The usable latent impression has been removed from the submitted items and forwarded to Latent Print Section Sacramento for a search of the automated files.

Enclosed are the submitted items.

Date of Report: February 24, 1986

RWK:vg

BFS-96

Examinations by:

Title:

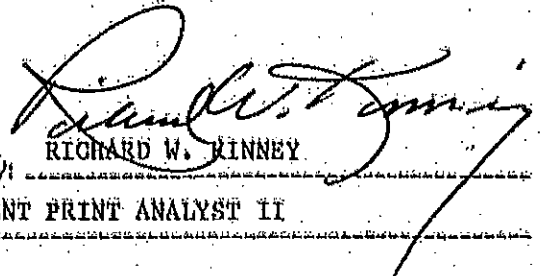
  
RICHARD W. RINNEY

LATENT PRINT ANALYST II